

# Soils Map

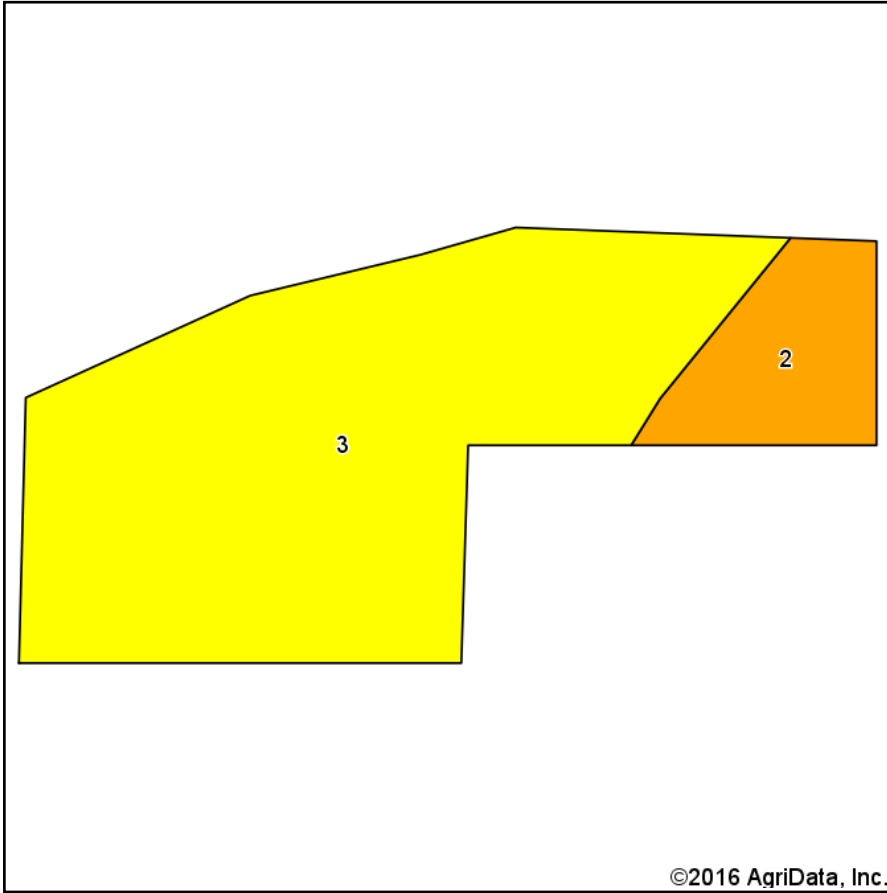

Soils data provided by USDA and NRCS.

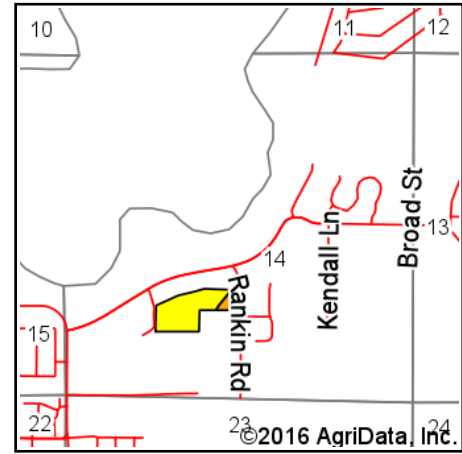

State: **Florida**  
 County: **Polk**  
 Location: **14-28S-26E**  
 Township: **Winter Haven-Auburndale**  
 Acres: **12.51**  
 Date: **12/16/2016**



## Area Symbol: FL105, Soil Area Version: 12

Code	Soil Description	Acres	Percent of field	Non-Irr Class Legend	Non-Irr Class *c	Range Production (lbs/acre/yr)	Grapefruit	Grapefruit Irrigated	Oranges Irrigated	*n NCCPI Overall
3	Candler sand, 0 to 5 percent slopes	10.71	85.6%		IVs	3000	562	615	21	16
2	Apopka fine sand, 0 to 5 percent slopes	1.80	14.4%		IIIs	3000				23
<b>Weighted Average</b>						<b>3000</b>	<b>481.1</b>	<b>526.5</b>	<b>18</b>	<b>*n 17</b>

Area Symbol: FL105, Soil Area Version: 12

\*n: NCCPI updated on 1-25-2016

\*c: Using Capabilities Class Dominant Condition Aggregation Method

Soils data provided by USDA and NRCS.